

L0LH0301 Obelix Thermistors Module Type A

The L0LH0301 Mining PLC Thermistor Module provides sixteen (16) inputs for monitoring resistive-type temperature sensors

Both PT100 and Thermistor type RTDs are supported. With built-in high voltage isolation; the module is very well suited to monitoring temperature sensors inside electric motor windings.

- **Embedded Thermistor Module**
16 Thermistor / RTD Inputs
Voltage 18VDC
Microprocessor Controlled
- **Outputs:** None
- **Connector 1:** Obelix A2
(24VDC Input + CAN Bus)
- **Connector 2:** Obelix A16
(Resistor Inputs and separate 12VAC supply)
- **CAN Network**
Opto-Coupler Isolation
CAN 2.0B Compatible
Throughput 500kbs (Supports Autobaud)
- **Operates -20°C to +70°C**
All industrial components
- **Heavy Duty Enclosure**
Electros Nickel Plated
Rugged Construction
- **Supply Input**
1: 24VDC (+/- 10%) / 3 Watts (Max) Supply Input
2: 12VAC (+/- 15%) / 2 Watts (Max)
- **Material**
Enclosure is Electroless nickel plated mild steel
Facia is stainless steel
Mounting brackets are stainless steel
- **Fasteners**
M5 x 10mm x 4
M4 x 10mm x 8
M3 x 10mm x 10
- **Mass**
2.5kg (5.5lb)



Typical Applications

- Continuous Bolter/Miners
- Continuous Haulage
- Long Wall Shearers
- Mobile Bolters
- Mobile Roof Supports
- Remote Control Scoops
- Remote Control Loaders
- Any industrial power supply application

L0LH0301 Obelix Thermistors Module Type A

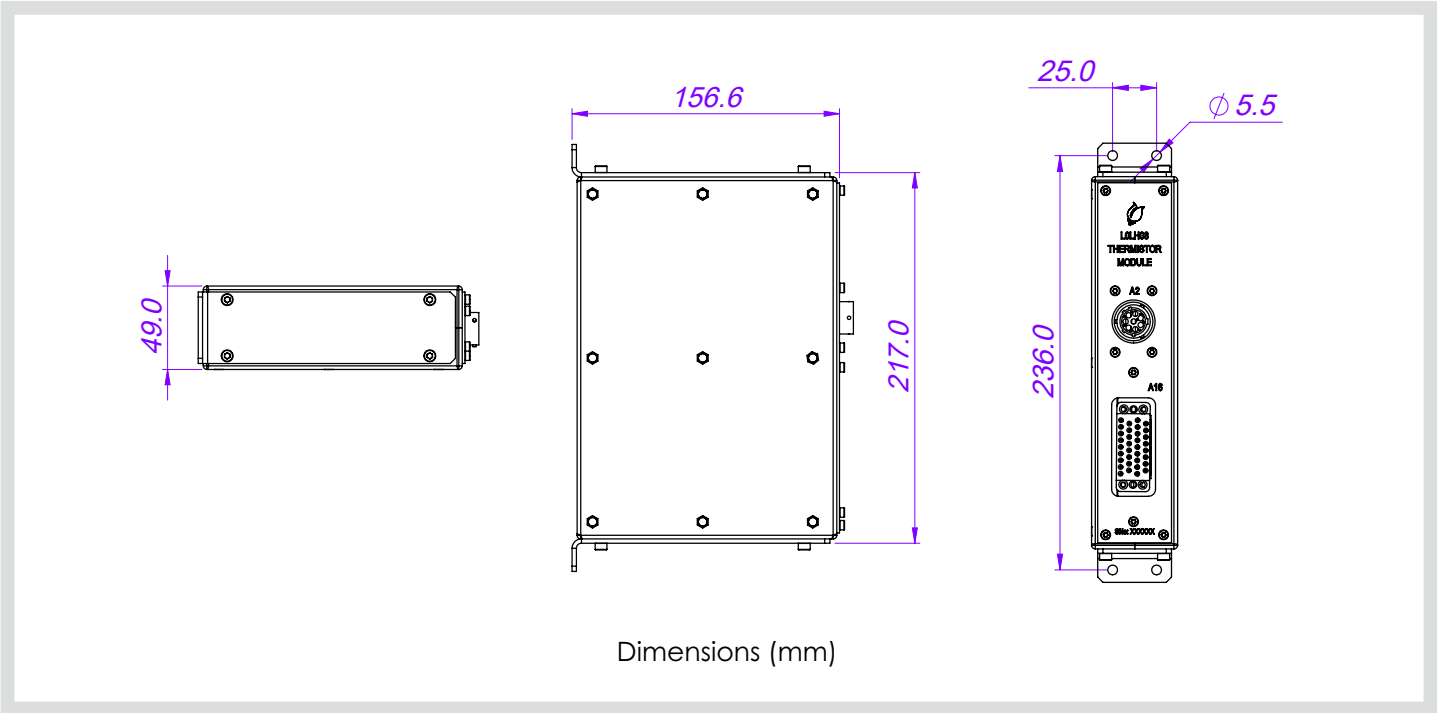

CONNECTOR A2

| PIN | Connector A2 Burndy Female 8 Way | Signal |
|------|--|------------------------|
| A2-A | Supply Input | 24VDC Supply Input |
| A2-B | Supply Input | 0VDC Supply Input |
| A2-C | CAN A (Positive) | Communications |
| A2-D | CAN A (Positive) | Communications |
| A2-E | CAN A (Negative) | Communications |
| A2-F | CAN A (Negative) | Communications |
| A2-G | Termination Link 1 - 1 | Termination Link Input |
| A2-H | Termination Link 1 - 2 | Termination Link Input |



L0LH0301 Obelix Thermistors Module Type A

CONNECTOR A16

| PIN | Connector A16 V35 Female 34 Way | Signal |
|--------|---------------------------------------|---------------|
| A14-A | Supply Input | 12VAC Active |
| A14-B | Supply Input | 12VAC Neutral |
| A14-C | Thermistor Input 1 (A) | 18VDC Supply |
| A14-D | Thermistor Input 1 (B) | 18VDC Return |
| A14-E | Thermistor Input 2 (A) | 18VDC Supply |
| A14-F | Thermistor Input 2 (B) | 18VDC Return |
| A14-H | Thermistor Input 3 (A) | 18VDC Supply |
| A14-J | Thermistor Input 3 (B) | 18VDC Return |
| A14-K | Thermistor Input 4 (A) | 18VDC Supply |
| A14-L | Thermistor Input 4 (B) | 18VDC Return |
| A14-M | Thermistor Input 5 (A) | 18VDC Supply |
| A14-N | Thermistor Input 5 (B) | 18VDC Return |
| A14-P | Thermistor Input 6 (A) | 18VDC Supply |
| A14-R | Thermistor Input 6 (B) | 18VDC Return |
| A14-S | Thermistor Input 7 (A) | 18VDC Supply |
| A14-T | Thermistor Input 7 (B) | 18VDC Return |
| A14-U | Thermistor Input 8 (A) | 18VDC Supply |
| A14-V | Thermistor Input 8 (B) | 18VDC Return |
| A14-W | Thermistor Input 9 (A) | 18VDC Supply |
| A14-X | Thermistor Input 9 (B) | 18VDC Return |
| A14-Y | Thermistor Input 10 (A) | 18VDC Supply |
| A14-Z | Thermistor Input 10 (B) | 18VDC Return |
| A14-AA | Thermistor Input 11 (A) | 18VDC Supply |
| A14-BB | Thermistor Input 11 (B) | 18VDC Return |
| A14-CC | Thermistor Input 12 (A) | 18VDC Supply |
| A14-DD | Thermistor Input 12 (B) | 18VDC Return |
| A14-EE | Thermistor Input 13 (A) | 18VDC Supply |
| A14-FF | Thermistor Input 13 (B) | 18VDC Return |
| A14-HH | Thermistor Input 14 (A) | 18VDC Supply |
| A14-JJ | Thermistor Input 14 (B) | 18VDC Return |
| A14-KK | Thermistor Input 15 (A) | 18VDC Supply |
| A14-LL | Thermistor Input 15 (B) | 18VDC Return |
| A14-MM | Thermistor Input 16 (A) | 18VDC Supply |
| A14-NN | Thermistor Input 16 (B) | 18VDC Return |



Image depict coding pins required

L0LH0301 Obelix Thermistors Module Type A

Connector Assembly

| Part Number | Description |
|-------------|------------------------|
| H0LH0101 | Connector Assembly A16 |

Connector Assembly Specifications

- **Product Type:** Pre-manufactured cable assembly
- **Construction:** Connector with flying leads (pigtail)
- **Connector 1 :** Obelix A16 Male Plug (34-pin)
- **Connector 2:** Unterminated, flying leads
- **Conductors:** 34
- **Cable Length:** 2.2 metres
- **Pin Type: Female** (Gold-plated)
- **Conductor Type:** PVDF Tinned Stranded Wire
- **Insulation Rating:** 600 volts
- **Temperature Rating:** -65°C to 105 °C
- **Recommended Tools:** PVDF / Teflon Insulation Stripping Tool

Cable options can vary depending on customer requirements.